

# 6000L CARTAGE TANK

## PRODUCT SPECIFICATION SHEET

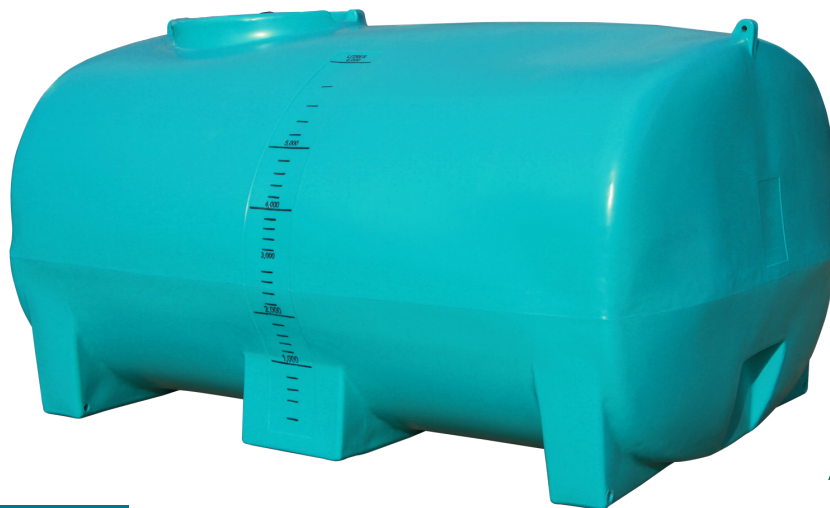

### UNIT SPECIFICATIONS

Item	Description	Details
Tank	6000L	UV stabilised chemical resistant polyethylene tank, lance & hose holder. 15 year warranty. Made in Australia
Lid	450mm	Threaded lid assembly with fixed labyrinth breather valve. UV Stabilised
Tank Outlet	2"	Stainless steel croc-loc tank outlet fitting
Dimensions		2790mm (L) x 2000mm (W) x 1556mm (H)
Load Rating	1.1:1 SG Aqua-V	Water only, Dry weight: 275kg
	1.3:1 SG Active Liquid	Water & non-hazardous liquids, Dry Weight: 300kg
	1.6:1 SG Mega Molasses	Molasses & liquid fertilisers, Dry Weight: 330kg
Colour	Teal	<i>*Note that tank colour can be customised</i>
Ball Baffles	ARB355 (Optional)	150 pieces of ARB355F ball baffles, made from food grade polypropylene
Mounting Pins	4 x Ø24mm mounting pins	Mounts directly to any flat surface with galvanised steel mounting pins (supplied)

### DIMENSIONAL DRAWING

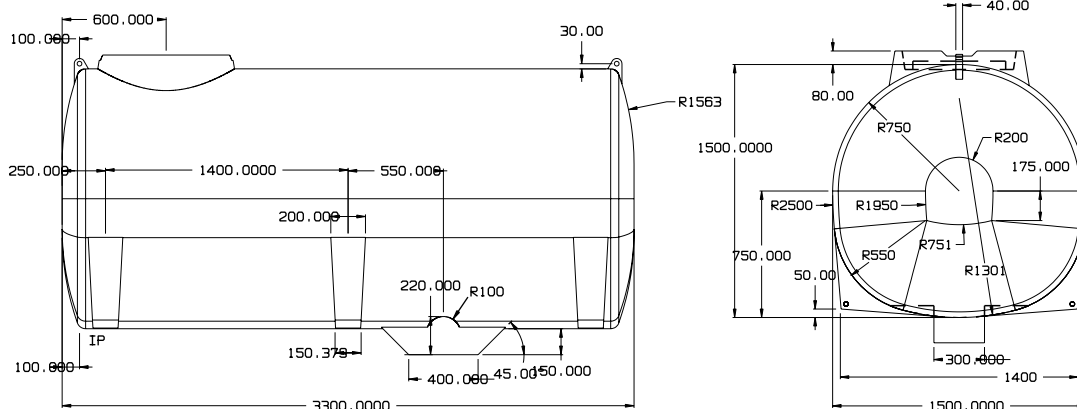

DISCOVER  
SAFER  
TANKERS  
WITH BALL  
BAFFLES.  
SCAN NOW!

