

Spray Tanks

Specification Sheet

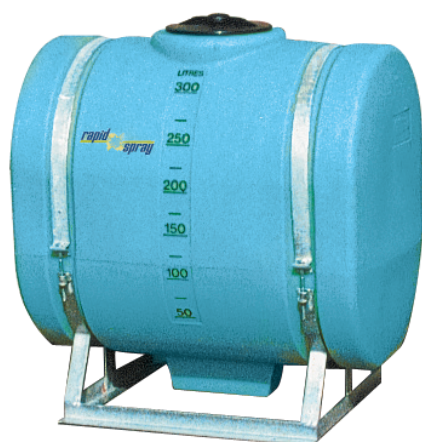

PTSS00300AKTT

300 Litre Strap Mount Spray Tank with Galvanised Steel Frame

| Unit Specifications | | |
|---------------------|--|---|
| Item | Description | Details |
| Tank | 300 litre | Manufactured from UV stabilised polyethylene specifically formulated for chemical spray tanks. Complies with AS2070:1999 & AS4766:300A6. Integral fully draining sump. 15 year guarantee. |
| Lid | 255mm | Ø255mm threaded lid assembly with fixed labyrinth breather valve |
| Filter | Basket Filter | Ø210mm x 235mm deep with 18 mesh screen |
| Tank outlet | 1 1/2" MBSP | Flanged polypropylene tank outlet fitting complete with nut and washer |
| Dimensions | PTSS00300ATT (Tank Only) | 940mm(L) x 600mm(W) x 925mm(H) |
| | PTSS00300AKTT (Tank and Frame) | 940mm(L) x 600mm(W) x 950mm(H) |
| Dry weight | PTSS00300ATT | 17kgs |
| | PTSS00300AKTT | 27kgs |
| Colour | | Teal translucent |
| Load rating | | 1.3 Specific Gravity (SG) |
| Mounting | Galvanised steel mounting frame and straps | Hot dipped galvanised steel mounting frame for correct tank support and to give sump clearance for access |

1

Spray Tanks

Specification Sheet

Features

- Integral fully draining sump
- The positive draining tank base with centred sump provides flooded suction regardless of terrain
- Unconditional guarantee against rust
- Extraordinary impact resistance
- Impressive range of "flex" to cope with movement and twisting in tough operating conditions
- Impervious to most chemicals
- Easy to read calibrations for measurement of contents
- Australian made for Australian conditions
- 15 year guarantee – buy with confidence!

Dimensional Drawing – PTSS00300ATT / PTSS00300AKTT

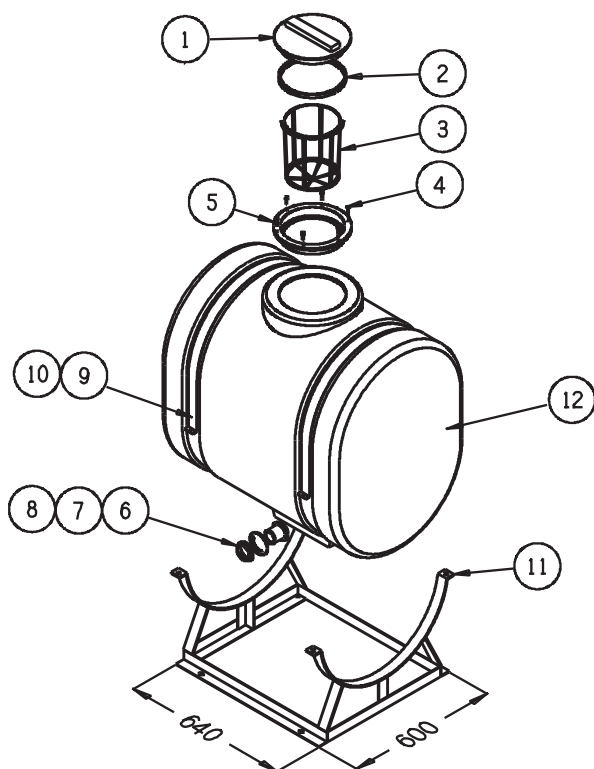

| OVERALL DIMENSIONS | | 940(L) x 600(W) x 980(H) |
|--------------------|---------------|----------------------------|
| ITEM | CODE | Description |
| 1,2,5 | ARLP250VSR | ø255 Lid Assembly Complete |
| 3 | ARK200 | ø255 Basket Filter |
| 4 | | Stainless Steel Screws |
| 6,7,8 | ARFP038 | 1 1/2" MBSP Fitting-Poly |
| 9,10,11 | | Frame & Straps Only |
| 12 | PTSS00300AATT | 300AL Tank - Bare |

2

Optional Tank Colours

Standard



Faint Green

Translucent



Natural



Trans Yellow



Trans Blue

- Optional colours may incur a surcharge of 5%
- If water is being stored in tank we recommend using opaque colours to prevent algae growth

Opaque



Rapid Blue



Light Blue



Heritage Green



Rapid Yellow



Red



White



Light Grey



Black

Optional Small Ball Baffle

– ARB195 Ø195MM

Displaces 150ml and weighs 120g. Recommended use quantity 1 ball baffle per 7L of tank capacity



*Tanks not mounted in accordance with our specifications may void warranty

Freecall 1800 011 000
www.rapidspray.net

